



All the power you need – without ever disturbing the fish

Yamaha Electric Drives are the most environment-friendly way to power your small boat when you're out relaxing on the water.

With these neat units, relaxation is the key. There is almost no noise and certainly no exhaust fumes, so you never have to worry about anything disturbing you – or about disturbing anything else, because for keen fishermen and lovers of nature that's the added bonus: a Yamaha Electric Drive won't scare wildlife away. So you can make the most of your day in the great outdoors.

Powered by compact 12-Volt batteries, your Yamaha Electric Drive is ultra-portable. Which also makes it perfect for a small tender or dinghy.



- One-Hand Stow
- Tilt/Extend Tiller
- Digital Maximizer™:
- Quick-Lock Cam Depth Adjuster
- Steering Tension Control
- Push-to-Test battery meter
- Power propeller
- Indestructible composite shaft
- Cool, quiet power

All the power you need – without ever disturbing the fish

The M20-M32 range is loaded with features that put your boat right where you need it, day in and day out. Versatile steering tension control. Easy One-Hand Stow. Quick depth adjustments.

The M32 is loaded with features that put your boat right where you need it, day in and day out. Versatile steering tension control. Easy One-Hand Stow. Quick depth adjustments.

When you reach back for your transom-mount motor, you need instant responsiveness, easy control, unyielding toughness and a reliable motor that you can count on for years. The M32 is exactly what you will get.

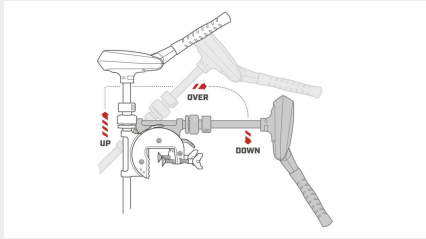

One-Hand Stow

Just pull up and forward to stow the motor with no buttons or release levers. Then when it's time to go, use the easy-access thumb release to deploy the M32 into any of ten different positions.



Quick Lock Cam Depth Adjuster

Change trim depths quickly, simply and securely. When you find your depth, this easy-to-use adjuster locks in tight to keep your Yamaha motor right where you want it.



Twist-on hand control

Benefit from an enhanced level of versatility with the Tilt/Extend Tiller handle, found on the M20. Offering tilt up to 45°, and extension up to 15cm, it's easy to adjust to any situation or style of fishing. The M20 also features a comfortable contoured grip.



Versatile steering tension control

An innovative collar, above the engine mount of the M32, makes it easy to adjust steering tension to the level you prefer. Keep it loose for effortless steering, or tighten it down to keep the engine more firmly in place, allowing for a 'stiffer' steering feel - or for stability when stowing the engine away.

Electric-Drive Technical specs

Amp Draw	42
Voltage	24
Mount Feature	One-hand Stow
Max Thrust (kg)	31.8
Speeds (FWD/REV)	Variable
Digital Maximizer	True
Shaft Length	1067 mm
Battery Meter	True
Control	Tilt/Extend Tiller

All information in this catalogue is given for general guidance only and is subject to change without prior notice. Photographs may show boats being driven by professionals and no recommendation or guidance in respect of safe operation or style of use is intended or implied by the publication of these images. Always respect the local maritime regulations. Always wear the recommended personal flotation device and safety equipment when boating.