

All the power you need – without ever disturbing the fish

Yamaha Electric Drives are the most environment-friendly way to power your small boat when you're out relaxing on the water.

With these neat units, relaxation is the key. There is almost no noise and certainly no exhaust fumes, so you never have to worry about anything disturbing you – or about disturbing anything else, because for keen fishermen and lovers of nature that's the added bonus: a Yamaha Electric Drive won't scare wildlife away. So you can make the most of your day in the great outdoors.

Powered by a compact 12-Volt battery, your Yamaha Electric Drive is ultra-portable. Which also makes it perfect for a small tender or dinghy.

- Push-to-Test meter - for easy battery level checks
- Very simple and light to carry about - and to fit
- Surprisingly powerful - but easy to control
- Tough construction and dependable 12-Volt motor
- Almost indestructible composite prop shaft
- Power propeller resists weeds and trailing debris
- Quick-Cam Depth Adjuster - easy prop depth control
- Extremely friendly to the environment
- Comfortable tiller with twist-on hand control
- Versatile steering tension control

All the power you need – without ever disturbing the fish

A Yamaha Electric Drive is the most convenient, environment-friendly way to power a small boat.

Incredibly simple and quiet to use, these compact 12-Volt units have adjustable brackets for quick, easy fitting, so you can go straight out, switch on and have fun. This M26 model features a twist-on hand control, offering a tilt angle of up to 45° extending up to 15cms - and with a comfortable contoured grip.

It's built tough too, with a permanent magnet motor, damage-resistant casing parts and coatings, and a special composite drive shaft that won't bend, break or corrode in normal use. A power propeller maximises thrust and resists trailing weeds and other underwater debris.

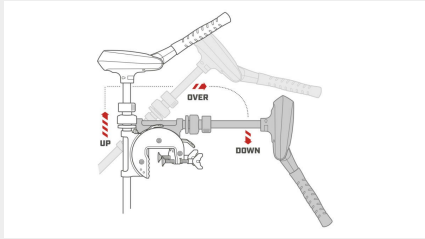

One-hand Stow

Just pull up on the motor to bring it in, and deploy it into any of ten positions with an easy-access thumb release.



Quick Lock Cam Depth Adjuster

Change the depth of the prop simply and securely with the Quick-Lock Cam Depth Adjuster. This clever feature makes adjustment simple - and locks in tightly, to keep your motor right where you want it.



Twist-on hand control

Benefit from an enhanced level of versatility with the Tilt/Extend Tiller handle, found on the M26. Offering tilt up to 45°, and extension up to 15cm, it's easy to adjust to any situation or style of fishing. The M26 also features a comfortable contoured grip.



Versatile steering tension control

An innovative collar, above the engine mount of the M26, makes it easy to adjust steering tension to the level you prefer. Keep it loose for effortless steering, or tighten it down to keep the engine more firmly in place, allowing for a 'stiffer' steering feel - or for stability when stowing the engine away.

Electric-Drive Technical specs

Amp Draw	50
Voltage	12
Mount Feature	One-hand Stow
Max Thrust (kg)	25
Speeds (FWD/REV)	Variable
Digital Maximizer	True
Shaft Length	914 mm
Battery Meter	True
Control	Tilt/Extend Tiller

All information in this catalogue is given for general guidance only and is subject to change without prior notice. Photographs may show boats being driven by professionals and no recommendation or guidance in respect of safe operation or style of use is intended or implied by the publication of these images. Always respect the local maritime regulations. Always wear the recommended personal flotation device and safety equipment when boating.